



Scanned 2012 file

Village of Menomonee Falls
 W156 N8480 Pilgrim Road
 Menomonee Falls, WI 53051-3140
 Telephone: (262) 532-4200

Rec 5/23/13
 Asbuilt

STORMWATER MANAGEMENT FACILITIES OPERATION AND INSPECTION REPORT

Quarter Section NE 1/4 Name of Business/Subdivision RCH Holdings, LLC
 Property Tax ID Number MNFV0053969 Address of Property Appleton Avenue
 Date 01/04/2013 Menomonee Falls

Dry Pond		Location of Pond	<u>Northeast corner of the lot</u>
Wet Pond	<u>X</u>		
Other			

Pond ID: SWP 14 N 007

Year Pond Constructed 2012 Year of Last Certification N/A

Compliance Verification	Design	Actual	Compliant		Comments (Condition of Structure)
			Yes	No	
Primary Outlet Pipe					Outlet Pipe Material
Opening Diameter (inches)	12	12	X		RCP
Upstream Invert	797.50	797.57	X		
Downstream Invert	797.32	797.28	X		
Length (feet)	35	35	X		
Slope (%)	0.5	0.83	X		
Secondary Outlet Pipe (If Applicable)					Outlet Pipe Material
Opening Diameter (inches)					
Upstream Invert					
Downstream Invert					
Length (feet)					
Slope (%)					
Riser (If Applicable)					Riser Material
Opening Diameter (inches)	24	24	X		
Elevation	802.00	801.94	X		
Upper Discharge Control (If Applicable)					
Opening Diameter (inches)	3.5	4		X	
Elevation	800.10	800.04	X		

Compliance Verification	Design	Actual	Compliant		Comments	
			Yes	No		
Lower Discharge Control	(If Applicable)					
Opening Diameter (inches)	2.8	2.8	X			
Elevation	797.50	797.48	X			
Other (Description)						
Opening Type and Size (inches)						
Elevation						
Emergency Spillway						
Elevation	802.50	802.90		X		
Length of spillway (feet)	30	10		X		
Embankment	Present Yes no		Comments/Maintenance Requirements			
Unauthorized Plantings, trees, or woody vegetation		X				
Animal burrows or slope erosion		X				
Storm Sewer Outfalls	Type & Size		Location		Comments	
Outfall 1	12" HDPE		West Side of Pond			
Outfall 2	12" HDPE		South Side of Pond			
Outfall 3						
Storage Properties	Design	Actual	Compliant		Not Applicable	Equipment Used
Normal Water Elevation (Wet Ponds)	797.50	797.48	X			
Design High Water Elevation	801.5	801.28	X			
Area at Normal Water Elevation (Ac) (Wet Ponds)	0.06	0.074	X			
Area at Design High Water Elevation (Ac)	0.410	0.412	X			
Active Storage Available (Ac-Ft)*	0.656	0.674	X			
Lowest Elevation at Top of Embankment (If Applicable)	802.5	802.9	X			
Average Elevation at Top of Embankment (If Applicable)	802.55	803.55		X		
Maximum Bottom Elevation	794.50	794.5	X			
Average Pond Bottom Elevation	794.50	794.5	X			
Pond Bottom Area (Ac)	0.0155	0.0155	X			
Maximum Pond Depth	9.5	9.5	X			
Average Pond Depth	8.05	9.05	X			
Average Permanent Pool Depth (Wet Ponds)	3.0	3.0	X			

*To Determine Active Storage $V=H/3(A1+A2+(A1 \times A2)^{1/2})$
Wet Ponds Use H = Height of Section , $A1$ = area at normal water elevation, $A2$ =area at top section
Dry Ponds Use H = Height of Section, $A1$ = pond bottom area, $A2$ =area at top section

Sketch Outlet or Attach to Document

(See As-Built Detention Pond Plan)



Attach As-built Survey to the Document for the first report submission

Inspection Firm: Quam Engineering, LLC Inspector Name: Kevin Parish
Phone Number: (262) 338-6641 Inspection Date: 12/18/2012
Address: 544 S. Main Street
Suite B
West Bend, WI 53095

Certifying Professional Name: Kevin J. Parish, P.E.
Phone Number: (262) 338-6641



Date: 1-4-13 Signature: [Handwritten Signature]

QUAM ENGINEERING, LLC 544 S. Main Street, Suite B, West Bend, WI 53095 (262) 338-6641 \DC-13-09\DC13BASE.DWG

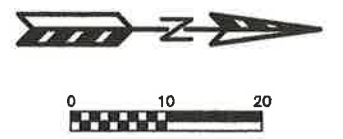
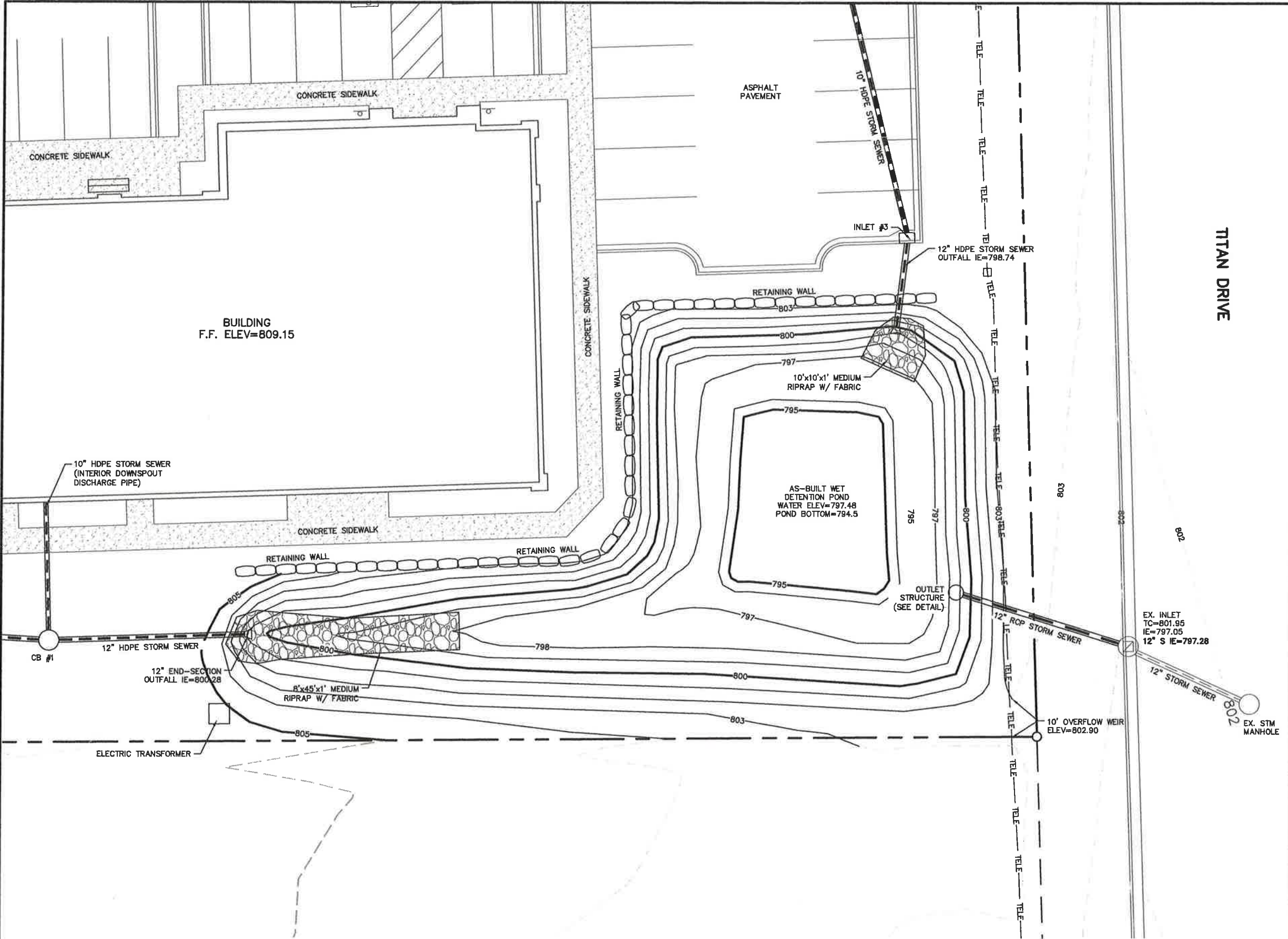

- LEGEND:**
- 803 — EXISTING MINOR CONTOUR.
 - - 805 - - EXISTING MAJOR CONTOUR.
 - 808 — AS-BUILT MAJOR CONTOUR.
 - 805 — AS-BUILT MAJOR CONTOUR.

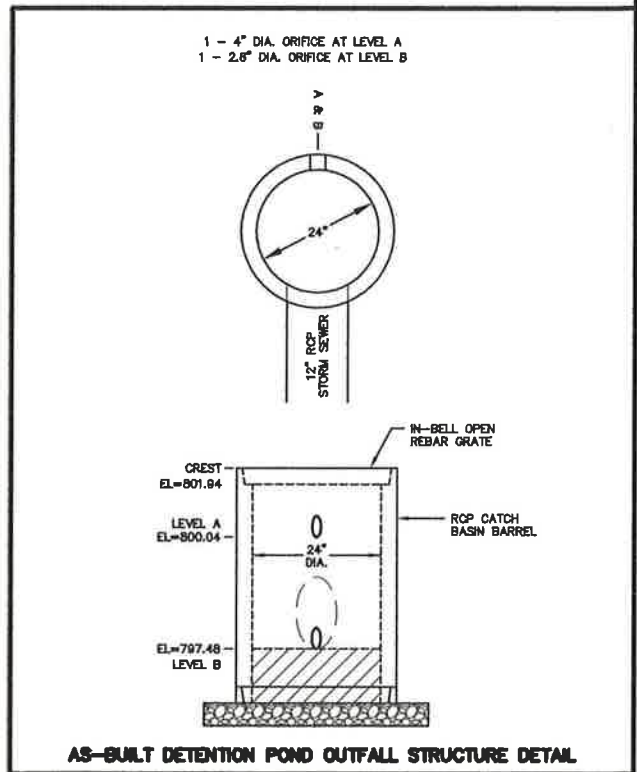

RCH HOLDINGS - APPLETON AVENUE
 AS-BUILT DETENTION POND PLAN
 PAGE: 1 OF 1
 DATED: JANUARY 4, 2013

QUAM ENGINEERING, LLC
 Residential and Commercial Site Design Consultants
 www.quamengineering.com
 544 South Main Street, Suite B; West Bend, Wisconsin 53095
 Phone (262) 338-6641; Fax (262) 338-6684