



Village of Menomonee Falls
 W156 N8480 Pilgrim Road
 Menomonee Falls, WI 53051-3140
 Telephone: (262) 532-4200

STORMWATER MANAGEMENT FACILITIES OPERATION AND INSPECTION REPORT

Quarter Section SE¼ Sec 13 Name of Business/Subdivision 401 Woodland Prime
 Property Tax ID Number MNF005299 Address of Property W126 N7449 Flint Drive
2014 Menomonee Falls, WI 53051
 Date May 17, 2013

Dry Pond	X		Location of Pond	South end of building
Wet Pond				
Other		Pond ID: <u>SWP13s015</u>		

Year Pond Constructed 2008 Year of Last Certification _____

Compliance Verification	Design	Actual	Compliant Yes No		Comments (Condition of Structure)
Primary Outlet Pipe					
Opening Diameter (inches)	18	18	X		Outlet Pipe Material Outlet pipe is located inside of concrete riser structure. Pipe is 18" Corrugated HDPE, and appears to be in good condition.
Upstream Invert	773.79	773.90	X		
Downstream Invert	768.10	768.10	X		
Length (feet)	220	224	X		
Slope (%)	2.6	2.6	X		
Secondary Outlet Pipe (If Applicable)					
Opening Diameter (inches)					Outlet Pipe Material
Upstream Invert					
Downstream Invert					
Length (feet)					
Slope (%)					
Riser (If Applicable)					
Opening Diameter (inches)	Not specified	48"x 48" square			Riser Material Top opening of concrete riser
Elevation	782.00	782.00	X		
Upper Discharge Control (If Applicable)					
Opening Diameter (inches)	3	3	X		*The concrete is uneven on the inside of the structure. The surveyor measured the invert at 778.85. I measured down from the top of concrete at exactly 36", therefore 779.00
Elevation	779.00	779.0*	X		

Sketch Outlet or Attach to Document



Attach As-built Survey to the Document for the first report submission

Inspection Firm: Site Engineering Services, LLC Inspector Name: Martin D. Worden, P.E.
Phone Number: 262/367-4960 Inspection Date: May 16, 2013
Address: 2920 Oakwood Road
Hartland, WI 53029

Certifying Professional Name: Martin D. Worden, P.E.
Phone Number: 262/367-4960

Date: 5/20/13

Signature: 

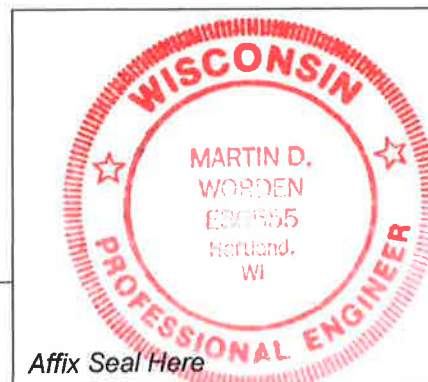

EXHIBIT

SITE ADDRESS

W126 N7449 Flint Drive, Village of Menomonee Falls, Waukesha County, Wisconsin,
being part of the Southeast 1/4 of Section 13, Town 8 North, Range 20 East.

TAX KEY NO.

MNFV0052992014

DATE

May 16, 2013

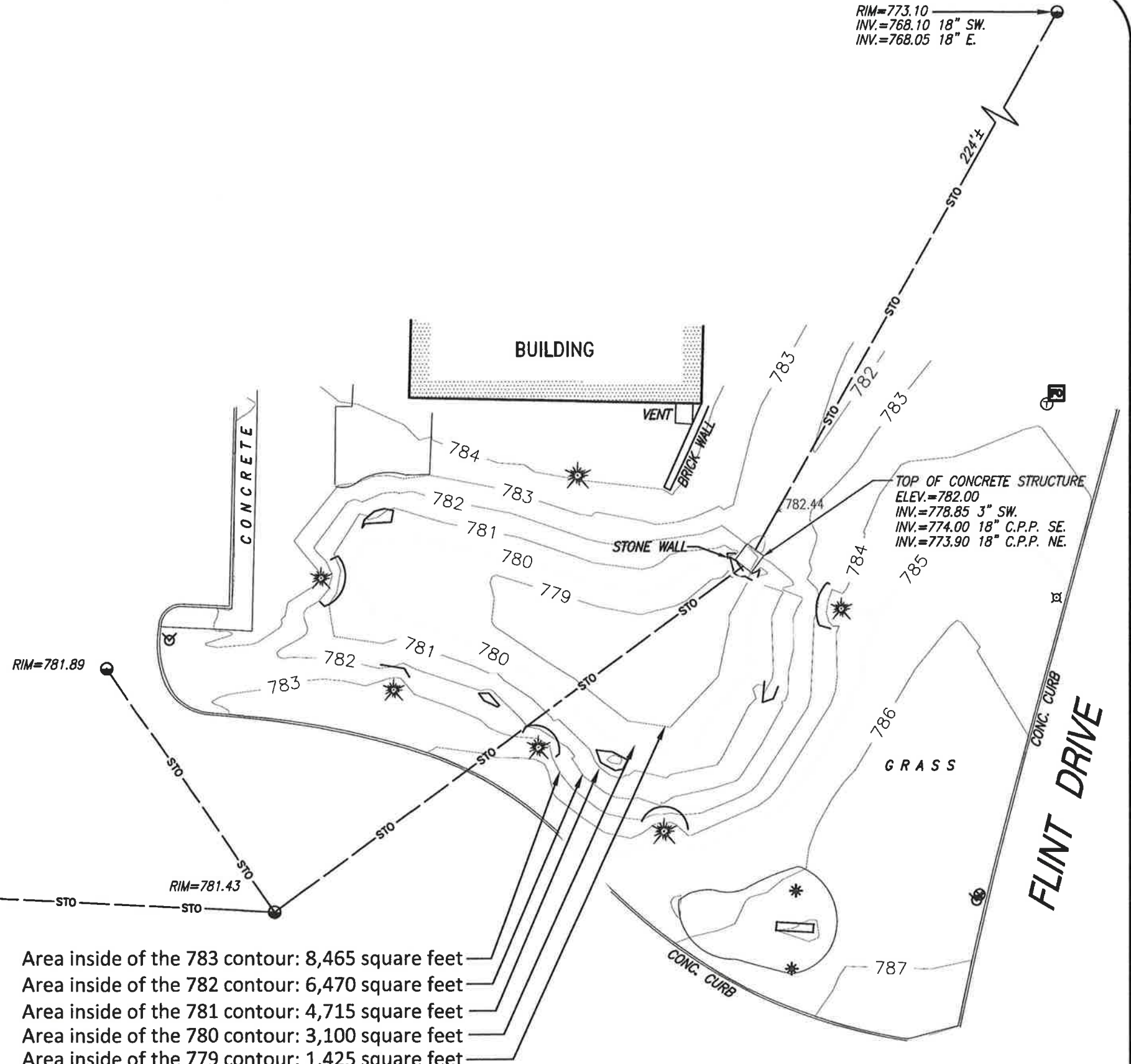
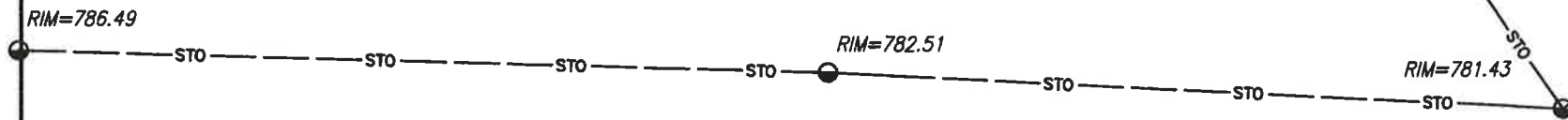

- Area inside of the 783 contour: 8,465 square feet
- Area inside of the 782 contour: 6,470 square feet
- Area inside of the 781 contour: 4,715 square feet
- Area inside of the 780 contour: 3,100 square feet
- Area inside of the 779 contour: 1,425 square feet

CHAPUT LAND SURVEYS LLC

234 W. FLORIDA STREET
MILWAUKEE, WI 53204
414-224-8068
www.chaputlandsurveys.com