



Village of Menomonee Falls  
 W156 N8480 Pilgrim Road  
 Menomonee Falls, WI 53051-3140  
 Telephone: (262) 532-4200

STORMWATER MANAGEMENT FACILITIES  
 OPERATION AND INSPECTION REPORT

Quarter Section SE 1/4 Sec. 24 Name of Business/Subdivision Lilly Creek Highlands IV  
 Property Tax ID Number 0096131 Address of Property \_\_\_\_\_

Dry Pond	<input checked="" type="checkbox"/>
Wet Pond	<input type="checkbox"/>
Other	<input type="checkbox"/>

Description: Pond #4

Location Of Pond Outlet 9

Year Pond Constructed 2006

Year of Last Certification 2006

Compliance Verification	Design	Actual	Compliant		Comments (Condition of Structure)
			Yes	No	
<b>Primary Outlet Pipe</b>					
Opening Diameter	12"	12"	✓		
Upstream Invert	776.19	775.85	✓		
Downstream Invert	775.24	775.18	✓		
Length	24	24	✓		
Slope	0.0104%	0.0279%	✓		
<b>Secondary Outlet Pipe</b> (If Applicable)					
Opening Diameter					
Upstream Invert					
Downstream Invert					
Length					
Slope					
<b>Riser</b> (If Applicable)					
Opening Diameter	24"x36"	24"x36"	✓		
Elevation	777.30	777.15	✓		
<b>Upper Discharge Control</b> (If Applicable)					
Opening Diameter					
Elevation					

Compliance Verification	Design	Actual	Compliant		Comments	
			Yes	No		
<b>Lower Discharge Control</b>	(If Applicable)					
Opening Diameter						
Elevation						
<b>Other (Description)</b>						
Opening Type	3.3" orifice	6" orifice	✓			
Elevation	776.0	775.85	✓			
<b>Emergency Spillway</b>						
Elevation	777.25	777.00	✓			
Length of spillway	10'	10'	✓			
<b>Embankment</b>			Present			
			Yes	No		
Unauthorized plantings, trees, or woody vegetation						
Animal burrows or slope erosion						
<b>Storage Properties</b>	Design	Actual	Compliant		Points Surveyed	Equipment Used
			Yes	No		
Normal Water Elevation (Wet Ponds)						
Design High Water Elevation	778.00	778.00	✓		20	GPS
Area at Normal Water Elevation (Ac) (Wet Ponds)					↓	
Area at Design High Water Elevation (Ac)	0.07Ac.	0.07Ac.	✓			
Active Storage Available (Ac-Ft)*	0.09	0.09	✓			
Lowest Elevation at Top of Embankment (If Applicable)	778.0	778.1	✓			
Average Elevation at Top of Embankment (If Applicable)	778.0	778.2	✓			
Maximum Bottom Elevation	776.0	776.1	✓			
Average Pond Bottom Elevation	776.0	775.9	✓			
Pond Bottom Area (Ac)	0.03Ac.	0.03Ac.	✓			
Maximum Pond Depth						
Average Pond Depth						

\*To Determine Active Storage  $V=H/3(A1+A2+(A1 \times A2)^{1/2})$

Wet Ponds Use  $H$  = Height of Section,  $A1$  = area at normal water elevation,  $A2$  = area at top section

Dry Ponds Use  $H$  = Height of Section,  $A1$  = pond bottom area,  $A2$  = area at top section

Sketch Outlet

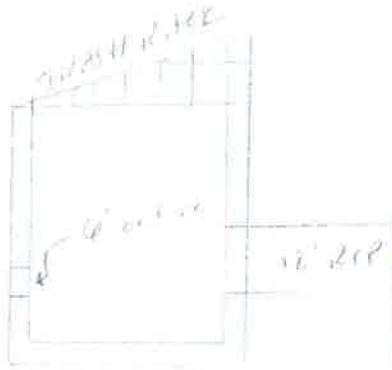

Inspection Firm: Land Tech Surveying and Engineering LLC  
Phone Number: 262-367-7544  
Address: P.O. Box 15  
Hartland, WI 53029

Inspector Name: John Downing  
Inspection Date: 8/17/11

Certifying Professional Name: Frederick Bower  
Phone Number: 262-255-5845



Date: 8-23-2011 Signature: Frederick Bower