

STORMWATER POND ASBUILT SURVEY

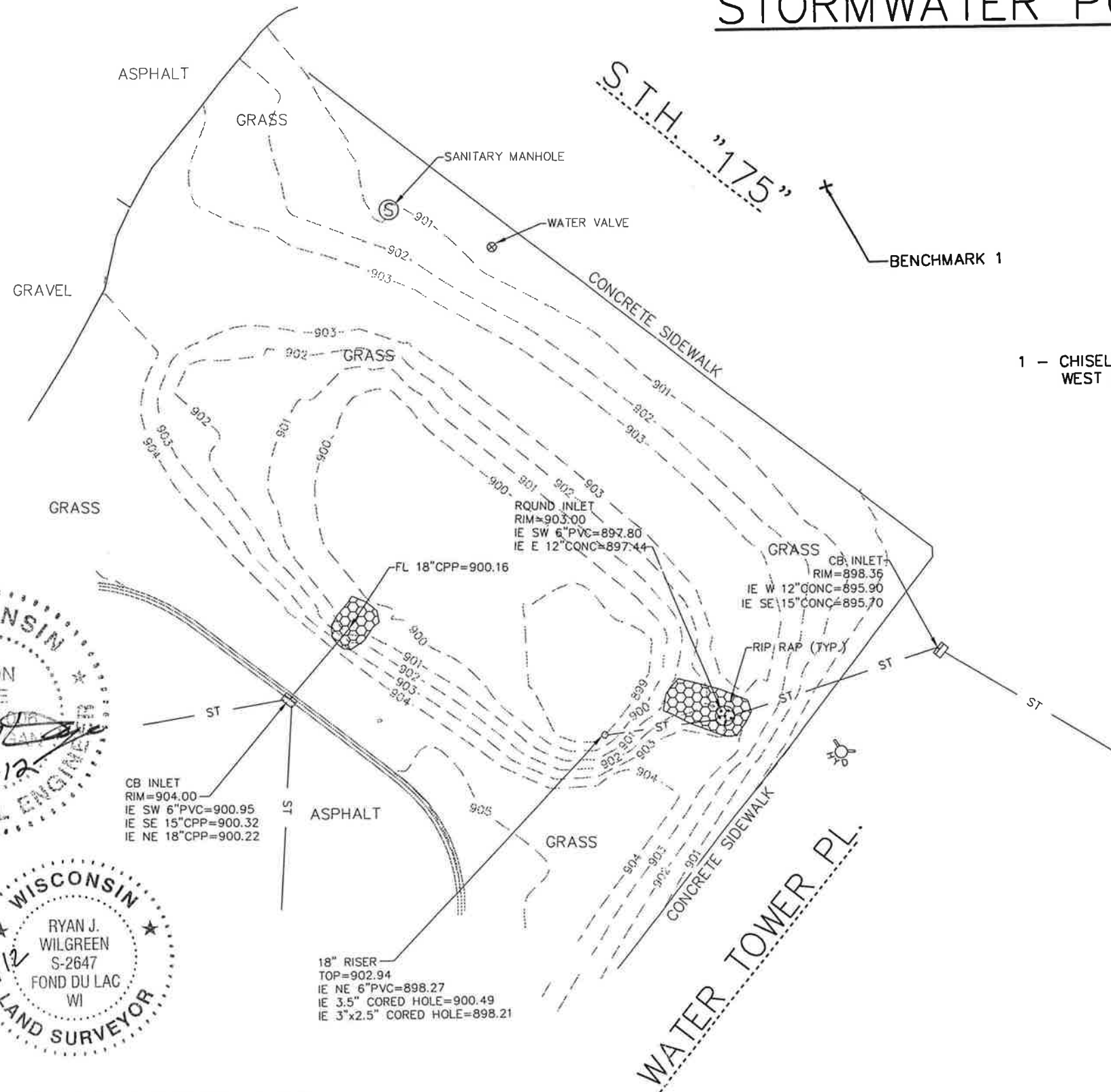

BENCHMARK

1 - CHISELED "X" ON TOP OF CURB ACROSS FROM BANK MUTUAL SIGN,
WEST SIDE OF SOUTHBOUND APPLETON AVENUE.
ELEV=900.75



STATE OF WISCONSIN) SS
FOND DU LAC COUNTY)

I, Ryan Wilgreen, a Wisconsin Registered Land Surveyor, hereby certify that the stormwater drainage patterns and detention pond shown hereon was mapped under my direct supervision and is a correct representation of conditions at the time of survey.

Ryan Wilgreen
Ryan Wilgreen, R.L.S. S-2647

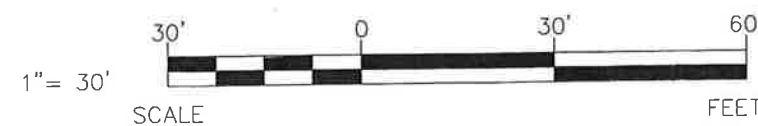

Bank Mutual



EXCEL
ENGINEERING Inc.
SURVEYING GROUP
PROJECT NO. 1216.300

Always a Better Plan
100 CAMELOT DRIVE
FOND DU LAC, WI 54935
PHONE: (920) 926-9800
FAX: (920) 926-9801