

STORMWATER MANAGEMENT FACILITIES OPERATION AND INSPECTION REPORT

| | | | |
|------------------------|---------|------------------------------|---------------------------|
| Quarter Section | 23 SW | Name of Business/Subdivision | LITTLE LEAGUE FIELDS |
| Property Tax ID Number | 0091999 | Address of Property | N64W15020 MILL RD |
| | | | MENOMONEE FALLS, WI 53051 |

| | | | | |
|----------|---|-------------------------------|------------------------------|-----------------------------|
| Dry Pond | X | Description: <u>SWP23S002</u> | Location Of Pond | LARGER PROPERTY N OF MILLRD |
| Wet Pond | | | N OF PAPOOSE DR | |
| Other | | | SE OF 2 N MOST BALL DIAMONDS | |

Year Pond Constructed 2006 Year of Last Certification 2011

| Compliance Verification | Design (Non-AsBuilt) | Actual (GPS) | Compliant Yes No | | Comments (Condition of Structure) |
|------------------------------|-------------------------|-----------------|------------------------|---|--|
| Primary Outlet Pipe | | | | | Outlet Pipe Material |
| Opening Diameter (inches) | 12” RCP | 15” RCP | X | - | RCP, GOOD CONDITION OVERHEAD CANOPY MAY HAVE COMPROMISED VERTICAL DATA OVERHEAD CANOPY MAY HAVE COMPROMISED VERTICAL DATA ELEVATIONS TO VARY SLIGHTLY FROM YEAR TO YEAR DUE TO GPS TECHNOLOGY |
| Upstream Invert (ST021151) | 815.40 | 816.54 | X | - | |
| Downstream Invert (ST021152) | 814.98 | 814.17 | X | - | |
| Length (feet) | 72.0 | 76.2 | X | - | |
| Slope (%) | 0.0050 | 0.0311 | X | - | |
| Secondary Outlet Pipe | | | | | Outlet Pipe Material |
| Opening Diameter (inches) | | | - | - | |
| Upstream Invert | | | - | - | |
| Downstream Invert | | | - | - | |
| Length (feet) | | | - | - | |
| Slope (%) | | | - | - | |
| Riser | N/A | | | | Riser Material |
| Opening Diameter (inches) | | | - | - | |
| Elevation | | | - | - | |
| Upper Discharge Control | N/A | | | | |
| Opening Diameter (inches) | | | - | - | |
| Elevation | | | - | - | |

| Compliance Verification | Design | Actual | Compliant Yes No | | Comments | |
|--|-------------------------|-----------------|-----------------------------------|---|------------------------------------|--|
| Lower Discharge Control | | | | | | |
| Opening Diameter (inches) | | | - | - | | |
| Elevation | | | - | - | | |
| Other (Description) | N/A | | | | | |
| Opening Type and Size (inches) | | | - | - | | |
| Elevation | | | - | - | | |
| Emergency Spillway | | | | | | |
| Elevation | 819.00 | 819.17 | X | - | | |
| Length of spillway (feet) | N/A | 32.0 | - | - | NE CORNER OF POND, N OF ST021151 ? | |
| Embankment | Present Yes No | | Comments/Maintenance Requirements | | | |
| Unauthorized Plantings, trees, or woody vegetation | X | - | WOODY VEGETATION PRESENT | | | |
| Animal burrows or slope erosion or hole | - | X | | | | |
| Storm Sewer Outfalls | Type & Size | | Location | | Comments | |
| Outfall 1 | - | | | | | |
| Outfall 2 | - | | | | | |
| Outfall 3 | - | | | | | |
| Outfall 4 | - | | | | | |
| Outfall 5 | - | | | | | |
| Storage Properties | Design (NON-ASBUILT) | Actual (GPS) | Compliant Yes No | | Not Applicable | Equipment Used |
| Normal Water Elevation (Wet Ponds) | | | - | - | N/A | GPS EQUIPMENT: GEOMAX ZENITH35 & CARLSON SURVEYOR2 WITH SURV CE v5.04 |
| Design High Water Elevation | 819.00 | 819.17 | - | - | | |
| Area at Normal Water Elevation (Ac) (Wet Ponds) | | | - | - | N/A | |
| Area at Design High Water Elevation (Ac) | N/A | 0.261 AC | - | - | | |
| Active Storage Available (Ac-Ft)* | 0.520 ACFT | 0.577 ACFT | - | - | | |
| Lowest Elevation at Top of Embankment (If Applicable) | 819.00 | 819.17 | X | - | | |
| Average Elevation at Top of Embankment (If Applicable) | 819.00 | 819.50 | - | - | | |
| Maximum Bottom Elevation | 815.40 | 816.54 | - | X | | |
| Average Pond Bottom Elevation | 817.50 | 817.70 | X | - | | |
| Pond Bottom Area (Ac) | N/A | 0.015 AC | X | - | | |
| Maximum Pond Depth | 3.60 | 2.63 | X | - | | |
| Average Pond Depth | 1.5 | 1.47 | X | - | | |
| Average Permanent Pool Depth (Wet Ponds) | | | - | - | N/A | |

*To Determine Active Storage $V = \left(\left(\frac{H}{3} \right) \left(A1 + A2 + \left(\left(A1 + A2 \right)^{\left(\frac{1}{2} \right)} \right) \right) \right)$

Wet Ponds Use H = Height of Section, $A1$ = area at normal water elevation, $A2$ =area at top section

Dry Ponds Use H = Height of Section, $A1$ = pond bottom area, $A2$ =area at top section

Little League Fields – SWP23S002

Overview



Storm Sewer Overflow/Inlet ST021151



Spillway ST021153



Little League Fields – SWP23S002

Storm Sewer Outlet ST021152



Little League Fields – SWP23S002

Repairs Needed (11/3/2022)

Clear brush from pond and embankments

| | |
|-----------------------------|--|
| <p><i>Sketch Outlet</i></p> | <p><i>Place Photograph of Pond</i></p> |
| | <p><i>Place Photograph of Pond</i></p> |

| | | | |
|------------------|--|------------------|---------------------------------|
| Inspection Firm: | VILLAGE OF MENOMONEE FALLS | Inspector Name: | CHRISTOPHER M GARIEPY |
| Phone Number: | 262-532-4411 | Inspection Date: | NOVEMBER 2 ND , 2022 |
| Address: | W156N8480 PILGRIM RD MENOMONEE FALLS, WI 53051 | | |

Certifying
 Professional Name: THOMAS M. HOFFMAN, P.E.
 Phone Number: 262-532-4415



| | |
|-------------------------------------|--|
| <p>Date:</p> <p><u>2/9/2023</u></p> | <p>Signature:</p> <p><u><i>[Handwritten Signature]</i></u></p> |
|-------------------------------------|--|

Affix Seal Here

Little League
Stormwater Facility
SWP23S002
SURVEYED 2022-1102 CMG



0 10 20 30 40
Feet
1 inch = 50 feet

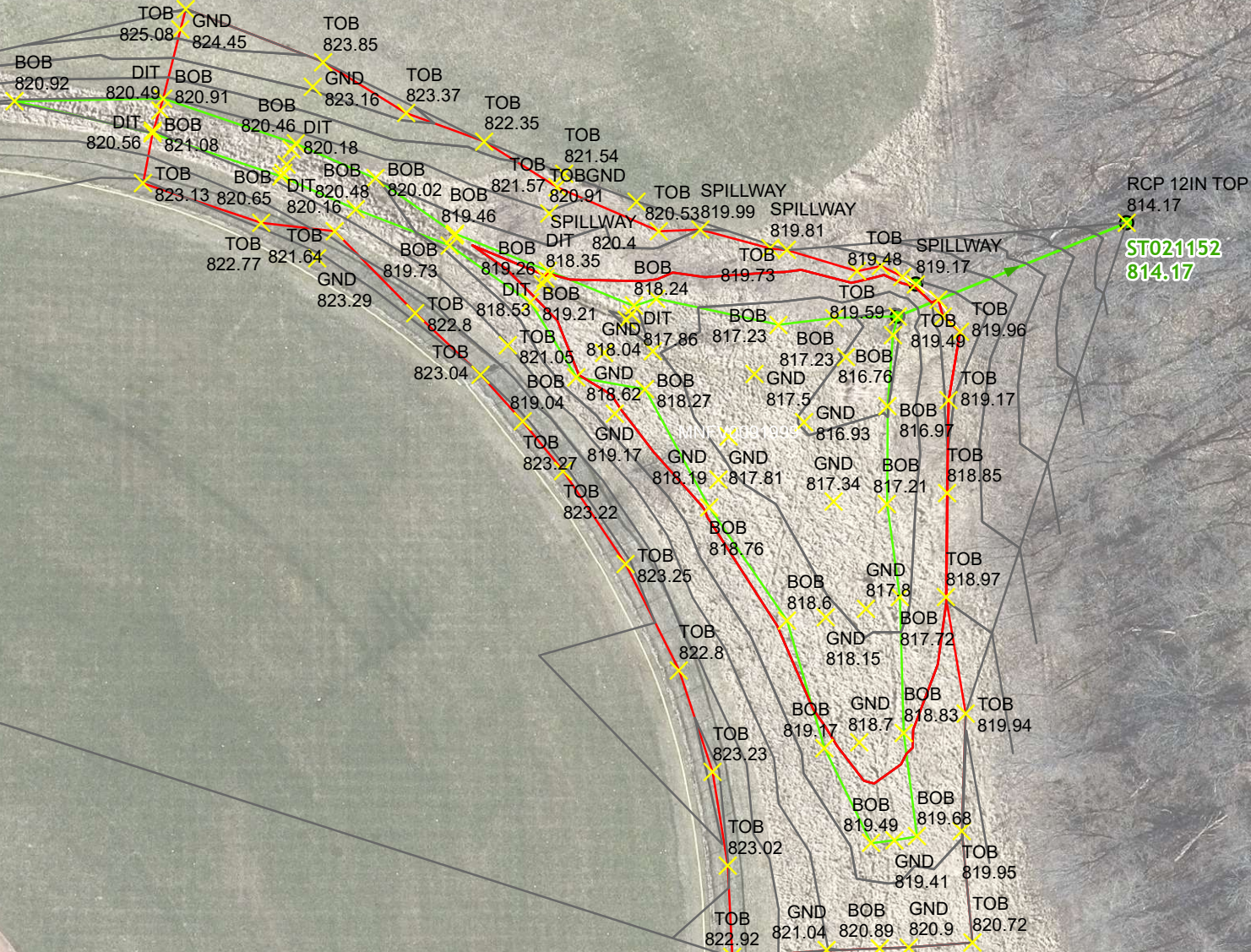

$$H = H_1 - H_2 = 819.17 - 817.00 = 2.17 \text{ FT}$$

$$A_1 = 66.18 \text{ F} = 0.015 \text{ AC}$$

$$A_2 = 11,336.08 \text{ F} = 0.261 \text{ AC}$$

2022
SWP235002

SWP235002 Little League Field

$$V = \left(\frac{H}{3} \right) (A_1 + A_2 + \sqrt{A_1 A_2})$$

$$V = \left(\frac{2.17 \text{ FT}}{3} \right) (0.015 \text{ AC} + 0.261 \text{ AC} + \sqrt{0.015 \text{ AC} \times 0.261 \text{ AC}})$$

$$V = (0.72 \text{ FT}) (0.276 \text{ AC} + \sqrt{0.276 \text{ AC}})$$

$$V = (0.72 \text{ FT}) (0.276 \text{ AC} + 0.525 \text{ AC})$$

$$V = (0.72 \text{ FT}) (0.801 \text{ AC})$$

$$V = 0.577 \text{ AC FT}$$

11/1/23
DGA

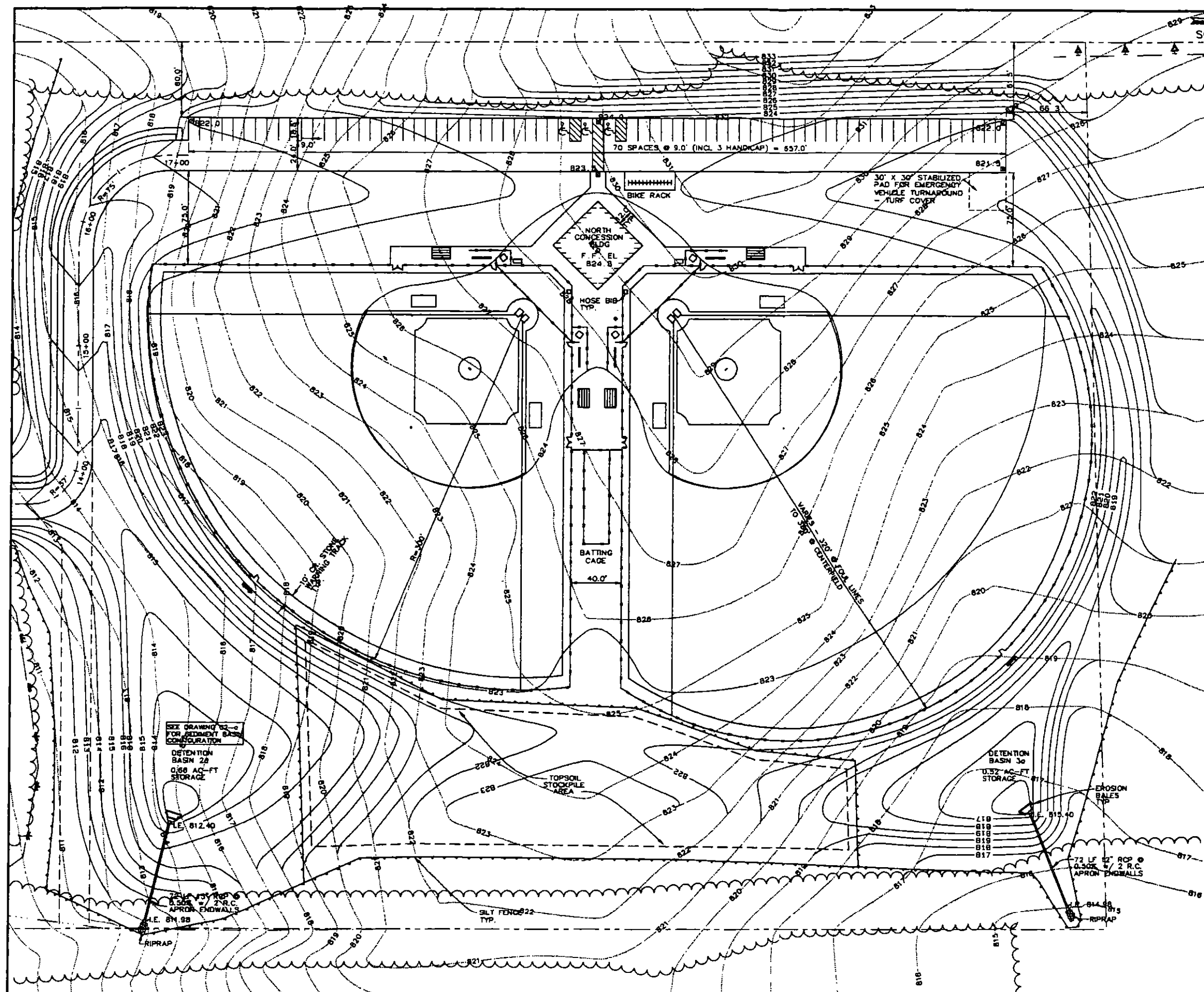

SCALE: 1"=40'

SITE DATA

| | |
|----------------------|---------------|
| SITE AREA | |
| PERVIOUS | = 27.70 ACRES |
| IMPERVIOUS | = 4.73 ACRES |
| TOTAL | = 32.43 ACRES |
| BUILDINGS (3) | |
| 70' x 70' | = 4900 SF |
| 50' x 50' | = 2500 SF |
| 20' x 30' | = 600 SF |
| TOTAL | = 8000 SF |
| PARKING | |
| STANDARD PARKING | = 267 SPACES |
| HANDICAP | = 10 SPACES |
| TOTAL | = 277 SPACES |

LEGEND

| EXISTING | PROPOSED | DESCRIPTION |
|----------|----------|--|
| -X-X- | -X-X- | FENCE |
| | -X-X- | SILT FENCE |
| | -X-X- | EROSION BALES |
| | -X-X- | WETLAND LIMITS |
| | -X-X- | TREE LINE |
| | -X-X- | FOREST LINE |
| | -X-X- | PROPERTY LINE |
| SS | SS | STORM SEWER |
| S | S | SANITARY SEWER |
| W | W | WATER |
| G | G | NATURAL GAS |
| T | T | TELEPHONE |
| E | E | ELECTRIC |
| | | TELEPHONE PEDESTAL |
| | | VALVE |
| | | MANHOLE |
| | | INLET |
| | | FIRE HYDRANT |
| | | SPOT ELEVATION |
| | | LIGHT POLE |
| | | CONTOURS |
| | | ASPHALTIC CONCRETE PAVEMENT (SEE NOTE 10.) |
| | | CONCRETE PAVEMENT |
| | | CONCRETE CURB & GUTTER |

NOTES:

1. ALL DIMENSIONS ARE TO EDGE OF PAVEMENT AND ARE TYPICAL UNLESS OTHERWISE NOTED.
2. EXISTING TOPOGRAPHY OBTAINED FROM FIELD SURVEY.
3. THE LOCATION OF EXISTING UTILITIES AS SHOWN ON THE SITE PLAN HAVE BEEN OBTAINED BY FIELD SURVEY AND/OR FROM PLANS PROVIDED BY THE VILLAGE OF MENOMONEE FALLS, AND ARE APPROXIMATE. THERE MAY BE OTHER UNDERGROUND UTILITIES NOT SHOWN.
4. SPOT ELEVATIONS SHOWN ARE TOP OF FINISHED PAVEMENTS.
5. ELEVATIONS SHOWN ARE U.S.G.S. DATUM.
6. SANITARY SEWERS SHALL BE PVC PIPE, ASTM D3034 OF SIZE INDICATED ON PLANS.
7. STORM SEWERS SHALL BE ASTM C78 CLASS IV REINFORCED CONCRETE PIPE, OF SIZE INDICATED ON PLANS.
8. ALL STORM AND SANITARY PIPING, MANHOLES AND INLETS, SHALL BE CONSTRUCTED IN ACCORDANCE WITH THE STANDARD SPECIFICATIONS FOR SEWER AND WATER CONSTRUCTION IN WISCONSIN.
9. BURIED WATER PIPING SHALL BE INSTALLED IN ACCORDANCE WITH THE WISCONSIN ADMINISTRATIVE CODE AND STANDARD SPECIFICATIONS FOR SEWER AND WATER CONSTRUCTION IN WISCONSIN.
10. ALL PAVED AREAS TO RECEIVE 6" CRUSHED AGGREGATE BASE COURSE (GRADATION NO. 2), 1 1/2" ASPHALTIC CONCRETE BINDER COURSE (TYPE MV), AND 1" ASPHALTIC CONCRETE SURFACE COURSE (TYPE MV). ALL PAVING SHALL BE CONSTRUCTED IN ACCORDANCE WITH THE STATE OF WISCONSIN DEPARTMENT OF TRANSPORTATION STANDARD SPECIFICATIONS FOR ROAD AND BRIDGE CONSTRUCTION, LATEST EDITION.
11. CONTRACTOR SHALL EMPLOY THE EROSION CONTROL PLAN AS SHOWN ON THE PLAN, WHICH IS IN CONFORMANCE WITH THE WISCONSIN CONSTRUCTION SITE BEST MANAGEMENT PRACTICE HANDBOOK. NO GRADING WORK WILL BEGIN UNTIL ALL EROSION CONTROL DEVICES ARE IN PLACE AND APPROVED BY MENOMONEE FALLS VILLAGE ENGINEER. ALL TOPSOIL STOCKPILES SHALL BE STABILIZED WITH TEMPORARY SEEDING AND BOUNDED BY SILT FENCE. PERMANENT SEEDING AND MULCHING WILL TAKE PLACE IMMEDIATELY FOLLOWING FINAL GRADING OPERATIONS.
12. OUTLET PIPES FOR ALL DETENTION PONDS MUST BE INSTALLED AT THE TIME THE PONDS ARE CONSTRUCTED.
13. SITE ELEVATION CAN BE UNIFORMLY ADJUSTED TO BALANCE CUTS AND FILLS. ROUGH GRADE ALL BASEBALL FIELDS ONE FOOT (1') BELOW ELEVATIONS SHOWN TO ALLOW FOR UNDERDRAIN SYSTEM - 4" OF PEA GRAVEL WITH 4" DRAIN PIPE AND SOCK, AND 8" MIXTURE OF TOPSOIL AND SAND. ROUGH GRADE ALL PROPOSED GRASS AREAS OUTSIDE OF BASEBALL FIELDS 4" BELOW ELEVATIONS SHOWN TO ALLOW FOR 4" TOPSOIL PLACEMENT.

| | | | | | | | | | | |
|-----------------|---|-----|----------|-----------------------------|-----|----------------------|--|---|-------------|---------|
| DESIGNED BY MCS | VERIFY SCALES | 1 | 9-8-95 | PER VILLAGE REVIEW COMMENTS | MCS | Applied Technologies | MENOMONEE FALLS LITTLE LEAGUE MENOMONEE FALLS, WISCONSIN | NORTH SITE, GRADING, PAVING & EROSION CONTROL PLAN | PROJECT NO. | DATE |
| DRAWN BY MCS | LENGTH OF BAR IS 1" ON ORIGINAL DRAWING | 2 | 10-16-95 | PER DNR REVIEW COMMENTS | MCS | | | | 1927 | 6-23-95 |
| CHECKED BY RCJ | IF BAR IS NOT 1" ON THIS DRAWING, ADJUST SCALE(S) ACCORDINGLY | | | | | | | | | |
| APPROVED BY | | | | | | | | | | |
| | | NO. | DATE | REVISION | BY | APVD | | | DRAWING NO. | C2 |

SITE DATA

SCALE: 1"=40'

| | |
|----------------------|---------------|
| SITE AREA | |
| PERVIOUS | = 27.70 ACRES |
| IMPERVIOUS | = 4.73 ACRES |
| TOTAL | = 32.43 ACRES |
| BUILDINGS (3) | |
| 70' x 70' | = 4900 SF |
| 50' x 50' | = 2500 SF |
| 20' x 30' | = 600 SF |
| TOTAL | = 8000 SF |
| PARKING | |
| STANDARD PARKING | = 267 SPACES |
| HANDICAP | = 10 SPACES |
| TOTAL | = 277 SPACES |

| NO. | PLANT |
|------|-------------------|
| 1. | TECHNEY ARBOVITAE |
| 2. | CHANTICLEER PEAR |
| 3. | REDMOND LINDEN |
| 4. | REDMAN MAPLE |
| 5. | REDMAN MAPLE |
| 6. | REDMAN MAPLE |
| 7. | REDMAN MAPLE |
| 8. | REDMAN MAPLE |
| 9. | REDMAN MAPLE |
| 10. | REDMAN MAPLE |
| 11. | REDMAN MAPLE |
| 12. | REDMAN MAPLE |
| 13. | REDMAN MAPLE |
| 14. | REDMAN MAPLE |
| 15. | REDMAN MAPLE |
| 16. | REDMAN MAPLE |
| 17. | REDMAN MAPLE |
| 18. | REDMAN MAPLE |
| 19. | REDMAN MAPLE |
| 20. | REDMAN MAPLE |
| 21. | REDMAN MAPLE |
| 22. | REDMAN MAPLE |
| 23. | REDMAN MAPLE |
| 24. | REDMAN MAPLE |
| 25. | REDMAN MAPLE |
| 26. | REDMAN MAPLE |
| 27. | REDMAN MAPLE |
| 28. | REDMAN MAPLE |
| 29. | REDMAN MAPLE |
| 30. | REDMAN MAPLE |
| 31. | REDMAN MAPLE |
| 32. | REDMAN MAPLE |
| 33. | REDMAN MAPLE |
| 34. | REDMAN MAPLE |
| 35. | REDMAN MAPLE |
| 36. | REDMAN MAPLE |
| 37. | REDMAN MAPLE |
| 38. | REDMAN MAPLE |
| 39. | REDMAN MAPLE |
| 40. | REDMAN MAPLE |
| 41. | REDMAN MAPLE |
| 42. | REDMAN MAPLE |
| 43. | REDMAN MAPLE |
| 44. | REDMAN MAPLE |
| 45. | REDMAN MAPLE |
| 46. | REDMAN MAPLE |
| 47. | REDMAN MAPLE |
| 48. | REDMAN MAPLE |
| 49. | REDMAN MAPLE |
| 50. | REDMAN MAPLE |
| 51. | REDMAN MAPLE |
| 52. | REDMAN MAPLE |
| 53. | REDMAN MAPLE |
| 54. | REDMAN MAPLE |
| 55. | REDMAN MAPLE |
| 56. | REDMAN MAPLE |
| 57. | REDMAN MAPLE |
| 58. | REDMAN MAPLE |
| 59. | REDMAN MAPLE |
| 60. | REDMAN MAPLE |
| 61. | REDMAN MAPLE |
| 62. | REDMAN MAPLE |
| 63. | REDMAN MAPLE |
| 64. | REDMAN MAPLE |
| 65. | REDMAN MAPLE |
| 66. | REDMAN MAPLE |
| 67. | REDMAN MAPLE |
| 68. | REDMAN MAPLE |
| 69. | REDMAN MAPLE |
| 70. | REDMAN MAPLE |
| 71. | REDMAN MAPLE |
| 72. | REDMAN MAPLE |
| 73. | REDMAN MAPLE |
| 74. | REDMAN MAPLE |
| 75. | REDMAN MAPLE |
| 76. | REDMAN MAPLE |
| 77. | REDMAN MAPLE |
| 78. | REDMAN MAPLE |
| 79. | REDMAN MAPLE |
| 80. | REDMAN MAPLE |
| 81. | REDMAN MAPLE |
| 82. | REDMAN MAPLE |
| 83. | REDMAN MAPLE |
| 84. | REDMAN MAPLE |
| 85. | REDMAN MAPLE |
| 86. | REDMAN MAPLE |
| 87. | REDMAN MAPLE |
| 88. | REDMAN MAPLE |
| 89. | REDMAN MAPLE |
| 90. | REDMAN MAPLE |
| 91. | REDMAN MAPLE |
| 92. | REDMAN MAPLE |
| 93. | REDMAN MAPLE |
| 94. | REDMAN MAPLE |
| 95. | REDMAN MAPLE |
| 96. | REDMAN MAPLE |
| 97. | REDMAN MAPLE |
| 98. | REDMAN MAPLE |
| 99. | REDMAN MAPLE |
| 100. | REDMAN MAPLE |

ALL DECIDUOUS TREES MUST BE TWO INCH CALIPER AT PLANTING. EVERGREENS 5-8 FEET IN HEIGHT AT PLANTING AND ALL SHRUBS MUST BE EITHER 2 1/2 GALLON OR 2 FEET IN HEIGHT AT PLANTING.

LEGEND

| EXISTING | PROPOSED | DESCRIPTION |
|----------|----------|--|
| --- | --- | FENCE |
| --- | --- | SILT FENCE |
| --- | --- | EROSION BALES |
| --- | --- | WETLAND LIMITS |
| --- | --- | TREE LINE |
| --- | --- | FOREST LINE |
| --- | --- | PROPERTY LINE |
| SS | SS | STORM SEWER |
| S | S | SANITARY SEWER |
| W | W | WATER |
| G | G | NATURAL GAS |
| T | T | TELEPHONE |
| E | E | ELECTRIC |
| □ | □ | TELEPHONE PEDESTAL |
| ○ | ○ | VALVE |
| ○ | ○ | MANHOLE |
| ○ | ○ | INLET |
| ○ | ○ | FIRE HYDRANT |
| ○ | ○ | SPOT ELEVATION |
| ○ | ○ | LIGHT POLE |
| --- | --- | CONTOURS |
| --- | --- | ASPHALTIC CONCRETE PAVEMENT (SEE NOTE 10.) |
| --- | --- | CONCRETE PAVEMENT |
| --- | --- | CONCRETE CURB & GUTTER |

NOTES

1. ALL DIMENSIONS ARE TO EDGE OF PAVEMENT AND ARE TYPICAL UNLESS OTHERWISE NOTED.
2. EXISTING TOPOGRAPHY OBTAINED FROM FIELD SURVEY.
3. THE LOCATION OF EXISTING UTILITIES AS SHOWN ON THE SITE PLAN HAVE BEEN OBTAINED BY FIELD SURVEY AND/OR FROM PLANS PROVIDED BY THE VILLAGE OF MENOMONEE FALLS AND ARE APPROXIMATE. THERE MAY BE OTHER UNDERGROUND UTILITIES NOT SHOWN.
4. SPOT ELEVATIONS SHOWN ARE TOP OF FINISHED PAVEMENTS.
5. ELEVATIONS SHOWN ARE U.S.G.S. DATUM.
6. SANITARY SEWERS SHALL BE PVC PIPE, ASTM D3034 OF SIZE INDICATED ON PLANS.
7. STORM SEWERS SHALL BE ASTM C76 CLASS IV REINFORCED CONCRETE PIPE, OF SIZE INDICATED ON PLANS.
8. ALL STORM AND SANITARY PIPING, MANHOLES AND INLETS, SHALL BE CONSTRUCTED IN ACCORDANCE WITH THE STANDARD SPECIFICATIONS FOR SEWER AND WATER CONSTRUCTION IN WISCONSIN.
9. BURIED WATER PIPING SHALL BE INSTALLED IN ACCORDANCE WITH THE WISCONSIN ADMINISTRATIVE CODE AND STANDARD SPECIFICATIONS FOR SEWER AND WATER CONSTRUCTION IN WISCONSIN.
10. ALL PAVED AREAS TO RECEIVE 6" CRUSHED AGGREGATE BASE COURSE (GRADATION NO. 2), 1 1/2" ASPHALTIC CONCRETE BINDER COURSE (TYPE IV), AND 1" ASPHALTIC CONCRETE SURFACE COURSE (TYPE IV). ALL PAVING SHALL BE CONSTRUCTED IN ACCORDANCE WITH THE STATE OF WISCONSIN DEPARTMENT OF TRANSPORTATION STANDARD SPECIFICATIONS FOR ROAD AND BRIDGE CONSTRUCTION, LATEST EDITION.
11. CONTRACTOR SHALL EMPLOY THE EROSION CONTROL PLAN AS SHOWN ON THE PLAN, WHICH IS IN CONFORMANCE WITH THE WISCONSIN CONSTRUCTION SITE BEST MANAGEMENT PRACTICE HANDBOOK. NO GRADING WORK WILL BEGIN UNTIL ALL EROSION CONTROL DEVICES ARE IN PLACE AND APPROVED BY MENOMONEE FALLS VILLAGE ENGINEER. ALL TOPSOIL STOCKPILES SHALL BE STABILIZED WITH TEMPORARY SEEDING AND BOUND BY SILT FENCE. PERMANENT SEEDING AND MULCHING WILL TAKE PLACE IMMEDIATELY FOLLOWING FINAL GRADING OPERATIONS.
12. SITE ELEVATION CAN BE UNIFORMLY ADJUSTED TO BALANCE CUTS AND FILLS. ROUGH GRADE ALL BASEBALL FIELDS ONE FOOT (1') BELOW ELEVATIONS SHOWN TO ALLOW FOR UNDERDRAIN SYSTEM - 4" OF PEA GRAVEL WITH 4" DRAIN PIPE AND SOCK, AND 8" MIXTURE OF TOPSOIL AND SAND. ROUGH GRADE ALL PROPOSED CRASS AREAS OUTSIDE OF BASEBALL FIELDS 4" BELOW ELEVATIONS SHOWN TO ALLOW FOR 4" TOPSOIL PLACEMENT.

| | | | | | |
|-----------------|---|-----|------|----------|----|
| DESIGNED BY MCS | VERIFY SCALES | | | | |
| DRAWN BY MCS | LENGTH OF BAR IS 1" ON ORIGINAL DRAWING | | | | |
| CHECKED BY RCJ | IF BAR IS NOT 1" ON THIS DRAWING, ADJUST SCALE(S) ACCORDINGLY | | | | |
| APPROVED BY | | NO. | DATE | REVISION | BY |

Applied Technologies

**MENOMONEE FALLS
LITTLE LEAGUE
MENOMONEE FALLS, WISCONSIN**

**NORTH SITE
LANDSCAPING PLAN**

| | |
|-------------|---------|
| PROJECT NO. | DATE |
| 1927 | 9-18-95 |
| DRAWING NO. | |
| L2 | |