



Village of Menomonee Falls
W156 N8480 Pilgrim Road
Menomonee Falls, WI 53051-3140
Telephone: (262) 532-4200

STORMWATER MANAGEMENT FACILITIES OPERATION AND INSPECTION REPORT

Quarter Section _____ Name of Business/Subdivision Spec-Shep
Property Tax ID Number MNFV Address of Property N79W14749 Appleton Ave.
0053027002
Date: September 25, 2020 Menomonee Falls, WI

Dry Pond	<input checked="" type="checkbox"/>	Location of Pond	North end of building
Wet Pond	<input type="checkbox"/>		
Other	<input type="checkbox"/>		

Pond ID: SWP14N002

Year Pond Constructed 2005 Year of Last Certification 2015

Compliance Verification	Design	Actual	Compliant Yes No		Comments (Condition of Structure)
Primary Outlet Pipe					Outlet Pipe Material
Opening Diameter (inches)	12"	12"	X		HDPE Outlet pipe in good condition, no clogging.
Upstream Invert	806.0	806.1	X		
Downstream Invert	805.8	805.90	X		
Length (feet)	±30	28.9	X		
Slope (%)	0.57%	0.69%	X		
Secondary Outlet Pipe	(If Applicable)				Outlet Pipe Material
Opening Diameter (inches)	-	-			
Upstream Invert	-	-			
Downstream Invert	-	-			
Length (feet)	-	-			
Slope (%)	-	-			
Riser	(If Applicable)				Riser Material
Opening Diameter (inches)	-	-			
Elevation	-	-			
Upper Discharge Control	(If Applicable)				
Opening Diameter (inches)	-	-			
Elevation	-	-			

Compliance Verification	Design	Actual	Compliant Yes No		Comments	
Lower Discharge Control	(If Applicable)					
Opening Diameter (inches)	-	-				
Elevation	-	-				
Other (Description)						
Opening Type and Size (inches)	-	-				
Elevation	-	-				
Emergency Spillway						
Elevation		809.5	X			
Length of spillway (feet)			X		±2.2' of curb cut that tapers to top of embankment elevation at 810	
Embankment	Present Yes No		Comments/Maintenance Requirements			
Unauthorized Plantings, trees, or woody vegetation		X	Cat tails throughout pond bottom and banks. Remove excess vegetation			
Animal burrows or slope erosion		X				
Storm Sewer Outfalls	Type & Size		Location		Comments	
Outfall 1	12" CMP		NE Side of pond		Excess vegetation and debris	
Outfall 2	12" HDPE		SE side of pond		Excess vegetation	
Outfall 3						
Storage Properties	Design	Actual	Compliant Yes No		Not Applicable	Equipment Used
Normal Water Elevation (Wet Ponds)					X	Estimate. Original intent Unknown Gps/Total station Gps/Total station Gps/Total station Gps/Total station
Design High Water Elevation	809.0	809.0	X			
Area at Normal Water Elevation (Ac) (Wet Ponds)					X	
Area at Design High Water Elevation (Ac)	1,250 s.f	1,200 s.f	X			
Active Storage Available (Ac-Ft)*		.05	X			
Lowest Elevation at Top of Embankment (If Applicable)		809.5			X	
Average Elevation at Top of Embankment (If Applicable)	809	810	X			
Maximum Bottom Elevation	806	806.1	X			
Average Pond Bottom Elevation	806.0	806.15	X			
Pond Bottom Area (Ac)	200 s.f	250 s.f	X			
Maximum Pond Depth	3.0'	3.4'	X			
Average Pond Depth	1.5	1.5				
Average Permanent Pool Depth (Wet Ponds)					X	

*To Determine Active Storage $V=H/3(A1+A2+(A1 \times A2)/2)$

Wet Ponds Use H = Height of Section , $A1$ = area at normal water elevation, $A2$ =area at top section

Dry Ponds Use H = Height of Section, $A1$ = pond bottom area, $A2$ =area at top section



Attach As-built Survey to the Document for the first report submission

Inspection Firm: Pinncale Engineering Group
 Phone Number: 262-754-8888
 Address: 20725 Watertown Road
 Suite 100
 Brookfield, WI 53186

Inspector Name : Adam Thurow
 Inspection Date: September 25, 2020

Certifying Professional Name: Mark Seidl
 Phone Number: 262-754-8792

Date: <u>10/22/20</u>	Signature: <u>[Handwritten Signature]</u>
-----------------------	---

 10/22/20
 Affix Seal Here

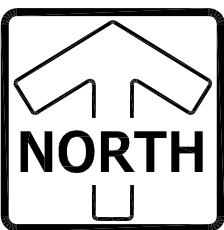

GRAPHICAL SCALE (FEET)

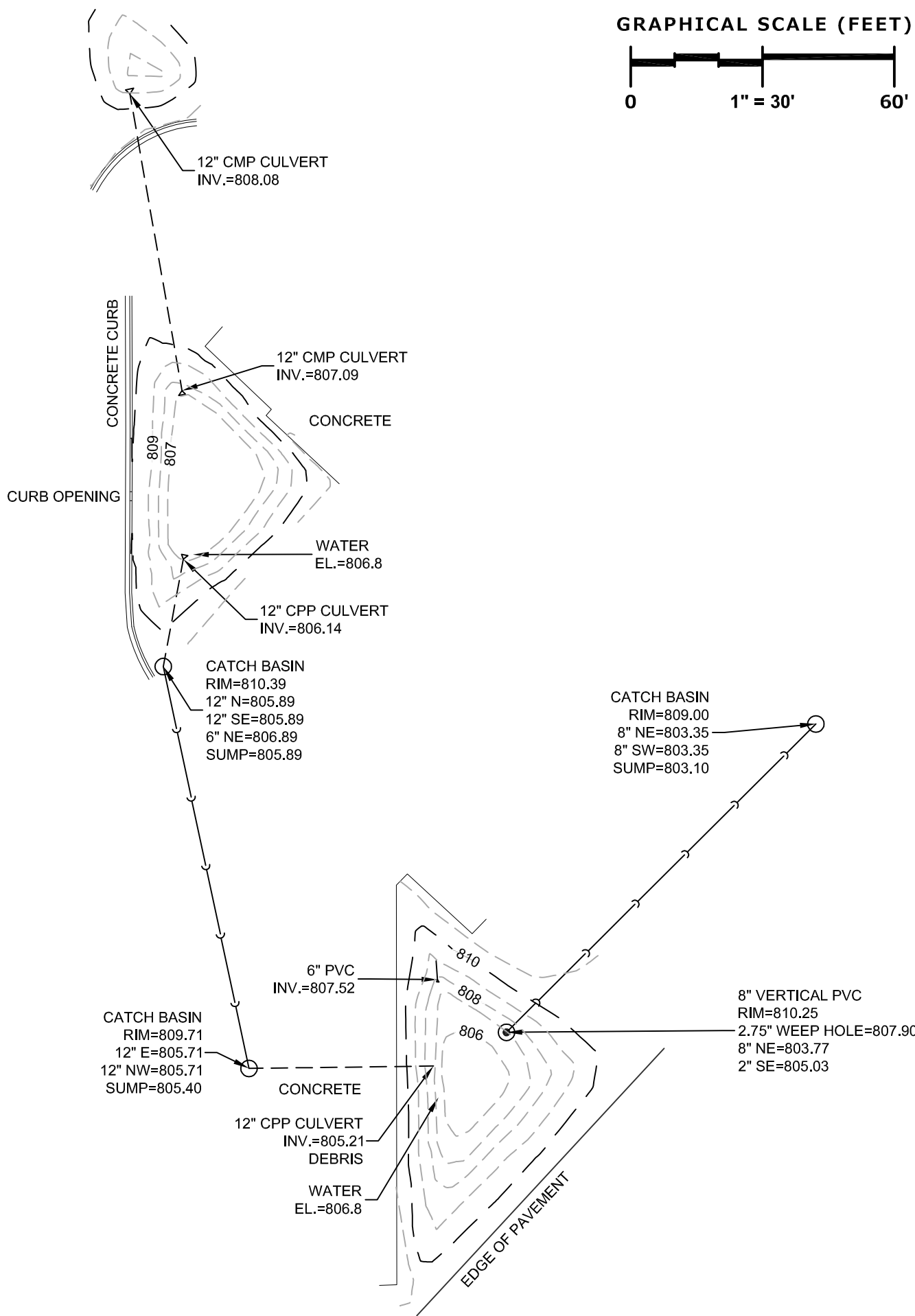
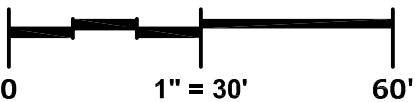

GENERAL NOTES

1. Address: N79W14749 Appleton Avenue, Menomonee Falls WI
2. Field work completed on SEPTEMBER 29, 2020.
3. Existing improvements graphically shown on this survey are limited to a predefined "Project Area" specified by the Owner/Client. Pinnacle Engineering Group, LLC takes no responsibility for improvements outside of this "Project Area".
4. Vertical Datum: National Geodetic Vertical Datum of 1929 (NGVD29). Contours are shown at a 1' interval based on actual ground survey of the current ground terrain. Reference Benchmark: Concrete monument with brass cap at the northwest corner of the Northeast 1/4 Section 14, Town 8 North, Range 20 East, Elevation = 805.73.