



Village of Menomonee Falls  
W156 N8480 Pilgrim Road  
Menomonee Falls, WI 53051-3140  
Telephone: (262) 532-4200

## STORMWATER MANAGEMENT FACILITIES OPERATION AND INSPECTION REPORT

Quarter Section \_\_\_\_\_ Name of Business/Subdivision Spec-Shep  
Property Tax ID Number MNFV Address of Property N79W14749 Appleton Ave.  
0053027002  
Date: September 25, 2020 Menomonee Falls, WI

Dry Pond	<b>X</b>	Location of Pond	Along southerly property line mid point.
Wet Pond			
Other			

Pond ID: SWP14N001

Year Pond Constructed 2005 Year of Last Certification 2015

Compliance Verification	Design	Actual	Compliant Yes    No		Comments ( Condition of Structure)
<b>Primary Outlet Pipe</b>					Outlet Pipe Material
Opening Diameter (inches)	2"	2"	X		PVC. Good condition. No clogging or cracking
Upstream Invert	805.0	805.03	X		
Downstream Invert					
Length (feet)					
Slope (%)					
<b>Secondary Outlet Pipe</b>	(If Applicable)				Outlet Pipe Material
Opening Diameter (inches)	-	-			
Upstream Invert	-	-			
Downstream Invert	-	-			
Length (feet)	-	-			
Slope (%)	-	-			
<b>Riser</b>	(If Applicable)				Riser Material
Opening Diameter (inches)	8"	8"	X		PVC. Good condition. No clogging or cracking
Elevation	810.25	810.25	X		
<b>Upper Discharge Control</b>	(If Applicable)				
Opening Diameter (inches)	-	-			
Elevation	-	-			

Compliance Verification	Design	Actual	Compliant Yes No		Comments	
<b>Lower Discharge Control</b>	(If Applicable)					
Opening Diameter (inches)	2.75"	2.75"	X			
Elevation	807.89	807.9	X			
<b>Other (Description)</b>						
Opening Type and Size (inches)	-	-				
Elevation	-	-				
<b>Emergency Spillway</b>						
Elevation	810	810.2	X			
Length of spillway (feet)			X		The overflow from the pond will head towards the Northeast.	
<b>Embankment</b>	Present Yes No		Comments/Maintenance Requirements			
Unauthorized Plantings, trees, or woody vegetation		X	Cat tails throughout pond bottom and banks. Remove excess vegetation			
Animal burrows or slope erosion		X				
<b>Storm Sewer Outfalls</b>	Type & Size		Location		Comments	
Outfall 1	6" PVC		NE Side of pond		Good condition	
Outfall 2	12" HDPE		North side of pond - middle		Excess vegetation. Could not locate	
Outfall 3						
<b>Storage Properties</b>	Design	Actual	Compliant Yes No		Not Applicable	Equipment Used
Normal Water Elevation (Wet Ponds)					X	Estimate. Original intent Unknown. Gps/Total Station  Gps/Total Station  Gps/Total Station
Design High Water Elevation						
Area at Normal Water Elevation (Ac) (Wet Ponds)					X	
Area at Design High Water Elevation (Ac)	1,850 s.f	1,900 s.f	X			
Active Storage Available (Ac-Ft)*		.05				
Lowest Elevation at Top of Embankment (If Applicable)	810	810.2	X			
Average Elevation at Top of Embankment (If Applicable)	810	810.5	X			
Maximum Bottom Elevation						
Average Pond Bottom Elevation	805	805.14	X			
Pond Bottom Area (Ac)	50 s.f.	55 s.f.	X			
Maximum Pond Depth	5.0	5.0	X			
Average Pond Depth	2.5	2.5	X			
Average Permanent Pool Depth (Wet Ponds)						

\*To Determine Active Storage  $V=H/3(A1+A2+(A1 \times A2)^{1/2})$   
 Wet Ponds Use  $H$  = Height of Section ,  $A1$ = area at normal water elevation,  $A2$ =area at top section  
 Dry Ponds Use  $H$ = Height of Section,  $A1$ = pond bottom area,  $A2$ =area at top section



*Attach As-built Survey to the Document for the first report submission*

Inspection Firm: Pinnacle Engineering Group  
 Phone Number: 262-754-8888  
 Address: 20725 Watertown Road  
Suite 100  
Brookfield, WI 53186

Inspector Name : Adam Thurow  
 Inspection Date: September 25, 2020

Certifying Professional Name: Mark Seidl  
 Phone Number: 262-754-8792

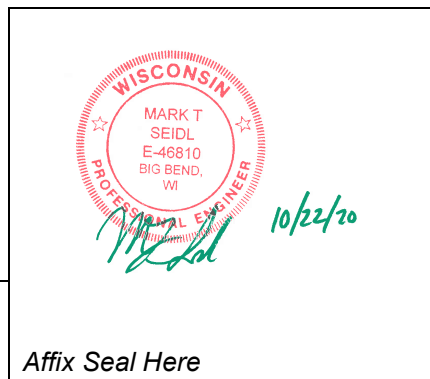

Date: 10/22/20 Signature: MS

*Affix Seal Here*



GRAPHICAL SCALE (FEET)

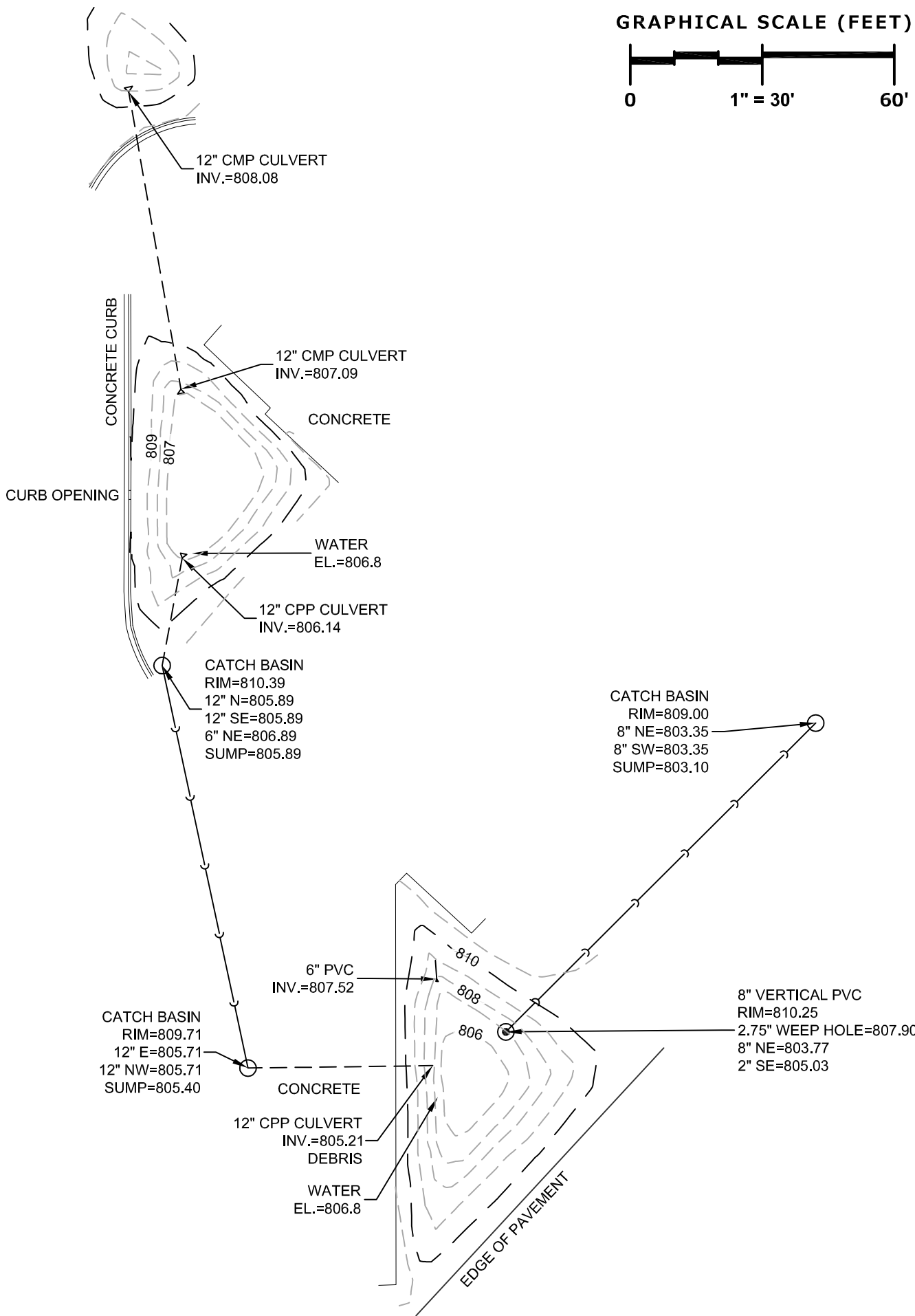
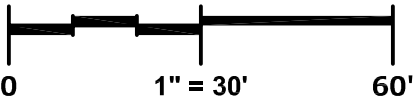

GENERAL NOTES

- 1. Address: N79W14749 Appleton Avenue, Menomonee Falls WI
- 2. Field work completed on SEPTEMBER 29, 2020.
- 3. Existing improvements graphically shown on this survey are limited to a predefined "Project Area" specified by the Owner/Client. Pinnacle Engineering Group, LLC takes no responsibility for improvements outside of this "Project Area".
- 4. Vertical Datum: National Geodetic Vertical Datum of 1929 (NGVD29). Contours are shown at a 1' interval based on actual ground survey of the current ground terrain. Reference Benchmark: Concrete monument with brass cap at the northwest corner of the Northeast 1/4 Section 14, Town 8 North, Range 20 East, Elevation = 805.73.