



Village of Menomonee Falls
W156 N8480 Pilgrim Road
Menomonee Falls, WI 53051-3140
Telephone: (262) 532-4200

STORMWATER MANAGEMENT FACILITIES OPERATION AND INSPECTION REPORT

Quarter Section NW 1/4 Sec
Property Tax ID Number 23-8-20 Name of Business/Subdivision Pilgrim Glen Condominium Plat
Addendum No. 2
0090-996-066
thru
0090-996-125 Address of Property Macallan Court
Date 8/31/20

Dry Pond	
Wet Pond	X
Other	

Pond ID: SWP23N003

Location of
Pond

SE Quadrant of Property

Year Pond
Constructed

2008

Year of Last
Certification

2015

Compliance Verification	Design	Actual	Compliant Yes No	Comments (Condition of Structure)
Primary Outlet Pipe				Outlet Pipe Material
Opening Diameter (inches)	12"	12'		Reinforced Concrete Pipe
Upstream Invert	825.00	825.10	✓	Accumulative silt at opening and bottom of outlet structure
Downstream Invert	824.49	824.07	✓	Recommend removal of silt.
Length (feet)	51.0	28.4	✓	
Slope	0.010 'f'	0.036 'f'	✓	
Secondary Outlet Pipe	(If Applicable)			Outlet Pipe Material
Opening Diameter (inches)				
Upstream Invert				
Downstream Invert				
Length (feet)				
Slope (%)				
Riser	(If Applicable)			Riser Material
Opening Diameter (inches)				
Elevation				
Upper Discharge Control	(If Applicable)			
Opening Diameter (inches)				
Elevation				

Compliance Verification	Design	Actual	Compliant Yes No		Comments	
Lower Discharge Control	(If Applicable)					
Opening Diameter (inches)	_____	_____				
Elevation	_____	_____				
Other (Description)						
Opening Type and Size (inches)	6" DIA.	6" DIA.			Vertical Orifice	
Elevation	825.00	824.71	✓			
Emergency Spillway						
Elevation	828.50	828.52	✓			
Length of spillway (feet)	20.0'	22.4'	✓			
Embankment	Present Yes no		Comments/Maintenance Requirements			
Unauthorized Plantings, trees, or woody vegetation	✓		Some vegetative growth around outlet structure. Recommend clearing for full function.			
Animal burrows or slope erosion		✓				
Storm Sewer Outfalls	Type & Size		Location		Comments	
Outfall 1 (ES-2.1)	RCP 24"		West Portion of Pond			
Outfall 2 (ES-2)	RCP 12"		Northwest Portion of Pond			
Outfall 3 (ES-1)	RCP 12"		Northwest Portion of Pond			
Storage Properties	Design	Actual	Compliant Yes No		Not Applicable	Equipment Used
Normal Water Elevation (Wet Ponds)	825.00	824.86	✓			Trimble R6 GPS HWL Calculated by HydroCAD Lowest Bottom Elevation
Design High Water Elevation	828.52	828.91	✓			
Area at Normal Water Elevation (Ac) (Wet Ponds)	0.530	0.502	✓			
Area at Design High Water Elevation (Ac)	1.020	0.915	✓			
Active Storage Available (Ac-Ft)*	2.667	2.869	✓			
Lowest Elevation at Top of Embankment (If Applicable)	829.50	828.68	✓			
Average Elevation at Top of Embankment (If Applicable)	829.50	829.11	✓			
Maximum Bottom Elevation	820.00	819.89	✓			
Average Pond Bottom Elevation	820.00	820.16	✓			
Pond Bottom Area (Ac)	0.223	0.205	✓			
Maximum Pond Depth	5.0'	5.0'	✓			
Average Pond Depth	5.0'	4.7'	✓			
Average Permanent Pool Depth (Wet Ponds)	5.0'	4.7'	✓			

*To Determine Active Storage $V=H/3(A1+A2+(A1 \times A2)^{1/2})$

Wet Ponds Use H = Height of Section , A1= area at normal water elevation, A2=area at top section

Dry Ponds Use H= Height of Section, A1= pond bottom area, A2=area at top section

Outlet Sketch

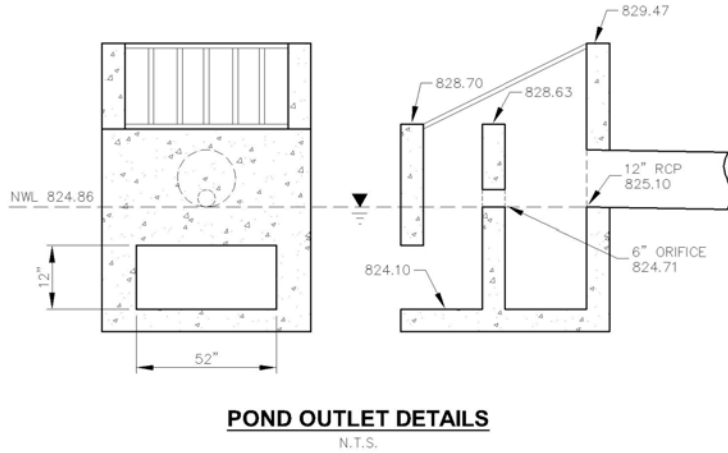

See Attached Photo Document

See Attached Photo Document

Attach As-built Survey to the Document for the first report submission

Inspection Firm:	<u>JSD Professional Services, Inc</u>	Inspector Name :	<u>Jay Averill</u>
Phone Number:	<u>(262) 513-0666</u>	Inspection Date:	<u>8/21/2020</u>
Address:	<u>W238 N1610 Busse Road</u>		
	<u>Suite 100</u>		
	<u>Waukesha, WI 53188</u>		

Certifying	
Professional Name:	<u>Rizal Iskandarsjach P.L.S., P.E.</u>
Phone Number:	<u>(262) 513-0666</u>



Date:

8/31/20

Signature:

Rizal Iskandarsjach

Affix Seal Here



Photo 1: SE side of pond, looking northwesterly.



Photo 2: SE side of pond, looking northeasterly.



Photo 3: Outlet structure front intake silted.



Photo 4: Outlet structure bottom silted.

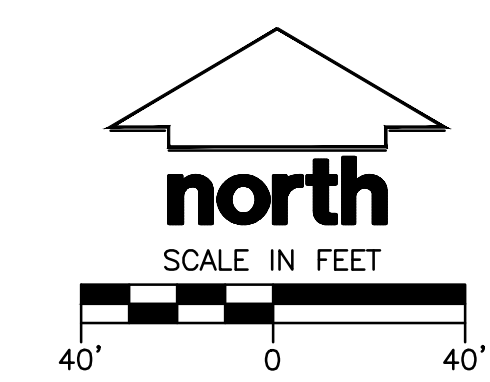
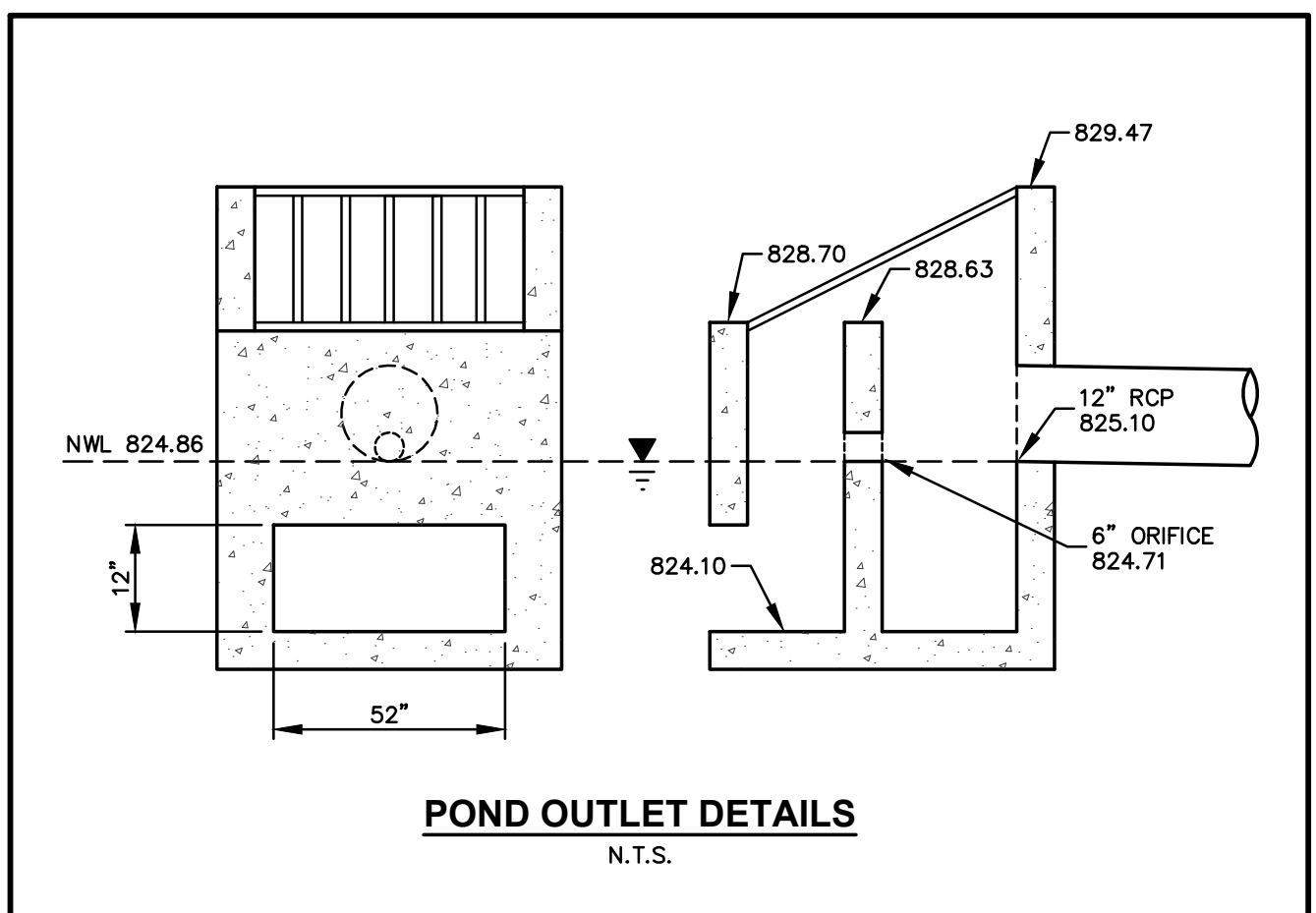
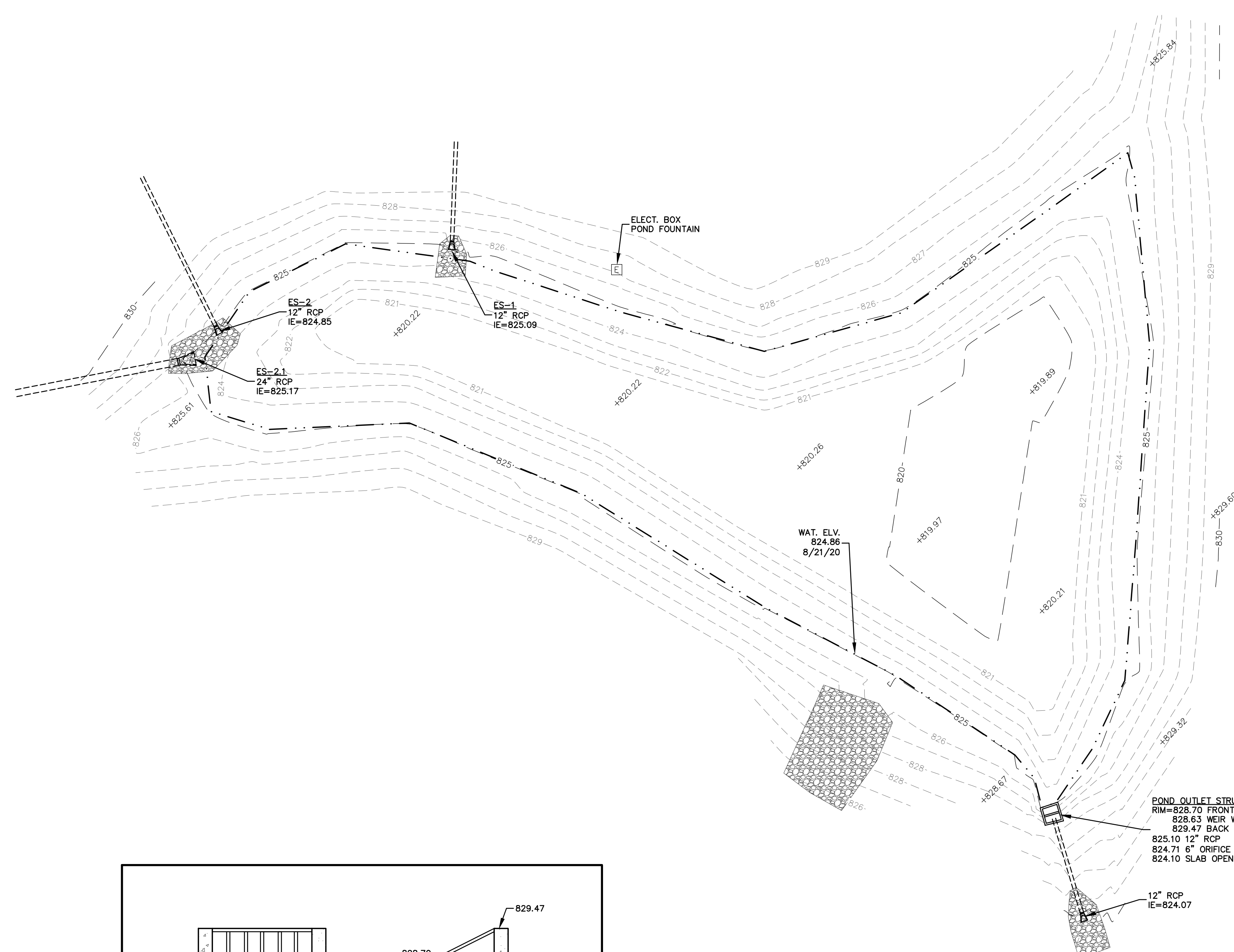

JSD Professional Services, Inc.
• Engineers • Surveyors • Planners

"BUILDING RELATIONSHIPS WITH A COMMITMENT TO CLIENT SATISFACTION THROUGH TRUST, QUALITY AND EXPERIENCE"

- CIVIL ENGINEERING
- SURVEYING & MAPPING
- CONSTRUCTION SERVICES
- WATER RESOURCES
- PLANNING & DEVELOPMENT
- TRANSPORTATION ENGINEERING
- LANDSCAPE ARCHITECTURE

MILWAUKEE REGIONAL OFFICE
W238N1610 BUSSE ROAD SUITE 100
WAUKESHA, WISCONSIN 53188
262.513.0866 PHONE | 262.513.1232 FAX

MADISON | MILWAUKEE | CHICAGO
KENOSHA | APPLETON | WAUSAU

www.jsdinc.com

SERVICES PROVIDED TO:
**PILGRIM GLEN
HOMEOWNER'S
ASSOCIATION**
ATTN: PROFESSIONAL
PROPERTIES
CONSULTANTS

PROJECT:
**PILGRIM GLEN CONDO
POND INSPECTION**

PROJECT LOCATION:
VILLAGE OF MENOMONEE FALLS
WAUKESHA COUNTY, WI

JSD PROJECT NO.: 20-9885

SEAL/SIGNATURE:

ALTHOUGH EVERY EFFORT HAS BEEN MADE IN PREPARING THESE PLANS AND CHECKING THEM FOR ACCURACY, THE CONTRACTOR AND SUBCONTRACTORS MUST CHECK ALL DETAIL AND DIMENSIONS OF THEIR TRADE AND BE RESPONSIBLE FOR THE SAME.

SURVEYED BY: JFA	08-21-20
DRAWN BY: RWI	08-31-20
CHECKED BY: RKW	08-31-20
PLAN MODIFICATIONS:	DATE:

DIGGERS HOTLINE

Call 811 or (800) 242-8511
Milwaukee Area (262) 432-7910
Hearing Impaired TDD (800) 542-2289
www.DiggersHotline.com

SHEET TITLE:
POND SWP23N003

SHEET NUMBER:
P-3.0

THESE PLANS AND DESIGNS ARE COPYRIGHT PROTECTED AND MAY NOT BE USED IN WHOLE OR IN PART WITHOUT THE WRITTEN CONSENT OF JSD PROFESSIONAL SERVICES, INC.